

8650

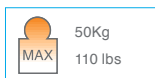

- Cerniera laterale per stipite stretto.
- Bisagra lateral.
- Side hinge for narrow door-jamb.
- Seitliches Scharnier Glas-Wand für schmale Türpfosten.
- Charnière latérale pour jambage étroit.

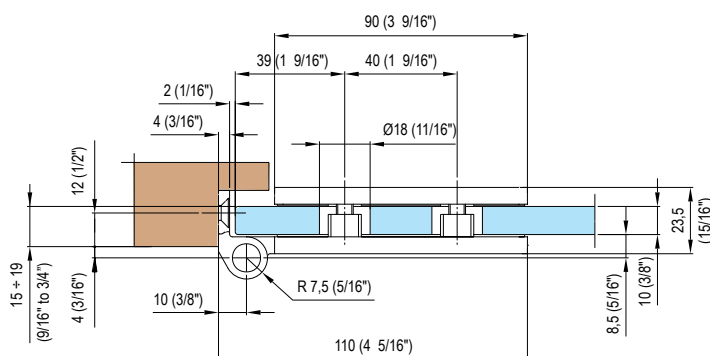
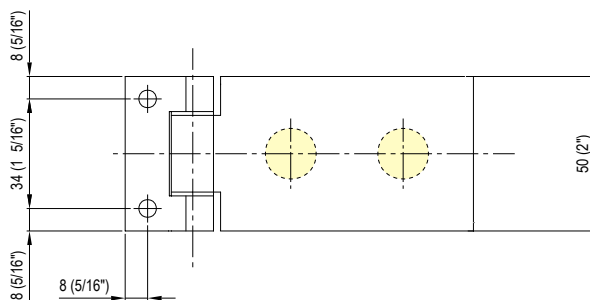
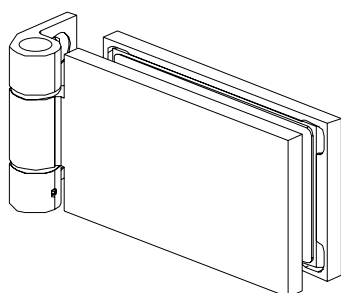

8652

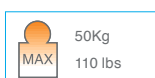

- Cerniera doppia vetro-vetro. 180°.
- Bisagra doble vidrio-vidrio. 180°.
- Double side hinge glass to glass. 180°.
- Doppelscharnier Glas-Glas. 180°.
- Double charnière verre-verre.

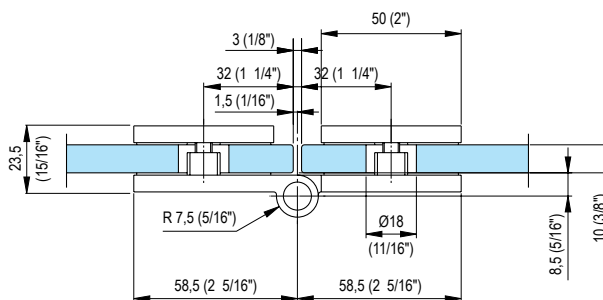
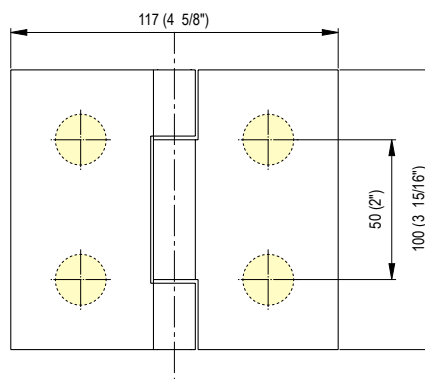
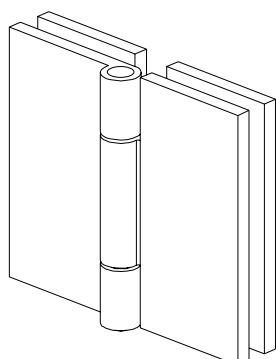

8653

8-10-12mm
5/16"-3/8"-1/2"

1000 mm
39.37"

60Kg
MAX
132 lbs

- Cerniera laterale per stipite stretto.
- Bisagra lateral.
- Side hinge for narrow door-jambs.
- Seitliches Scharnier für schmale Türpfosten.
- Charnière latérale pour jambage étroit.

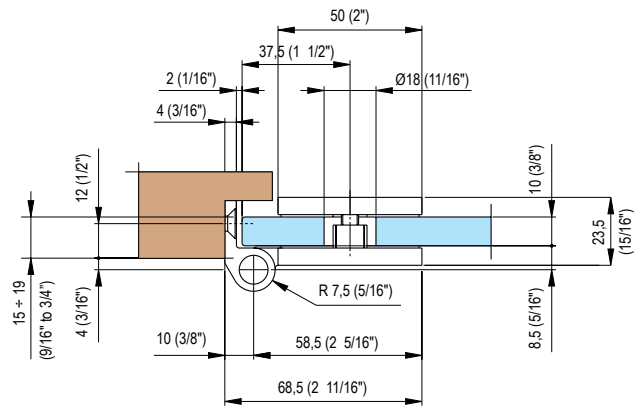
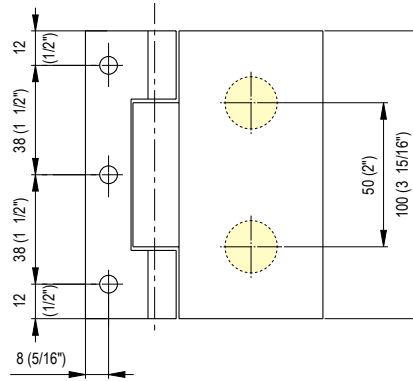
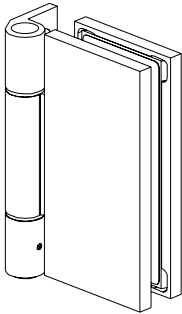

8654

6-8-10mm
5/16"-3/8"

800 mm
31.49"

44Kg
MAX
97 lbs

- Cerniera laterale per stipite stretto.
- Bisagra lateral pequeña.
- Side hinge for narrow door-jambs.
- Seitliches Scharnier für schmale Türpfosten.
- Charnière latérale pour chambranle étroit.

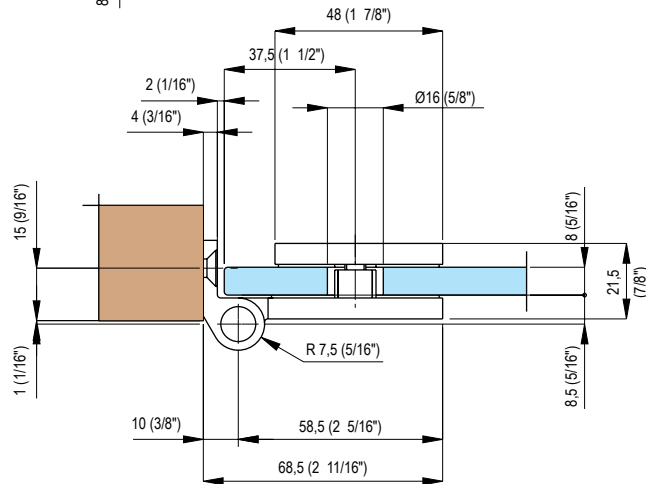
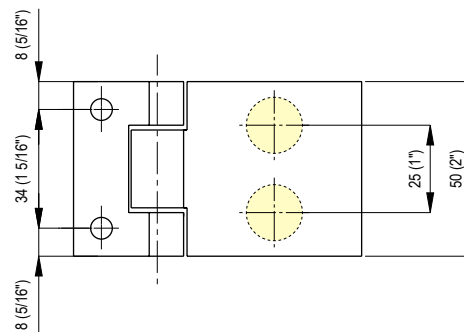
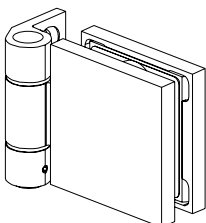

8655

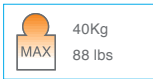
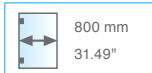
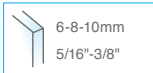

• Cerniera laterale piccola vetro-vetro. 180°.

• Bisagra lateral pequeña vidrio-vidrio. 180°.

• Small side hinge glass to glass. 180°.

• Kleines, seitliches Scharnier Glas-Glas. 180°.

• Petite charnière latérale verre-verre 180°.

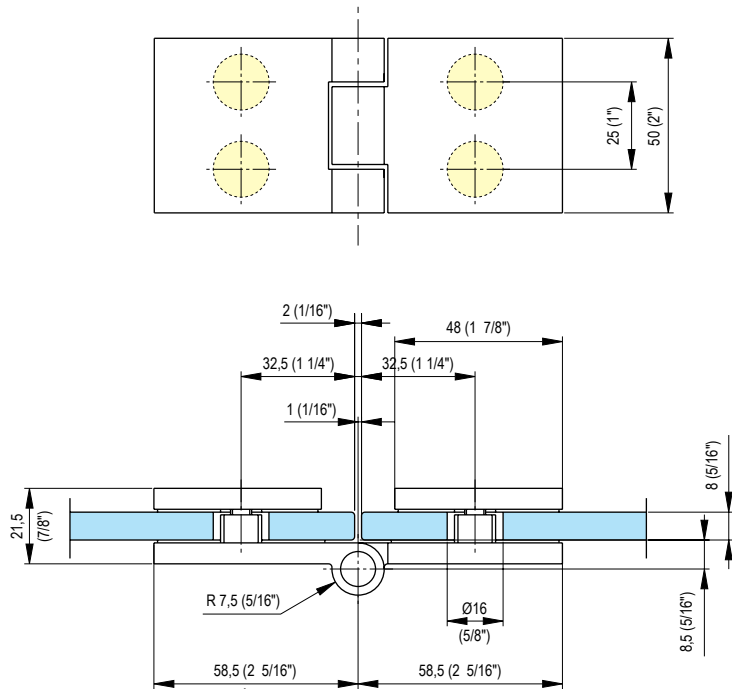
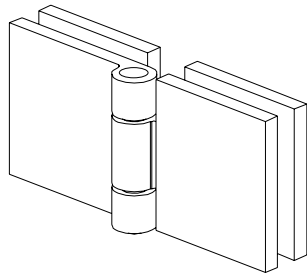

8660

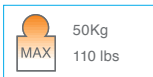
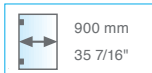
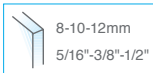

• Cerniera laterale tonda per stipiti da 20 a 30mm.

• Bisagra lateral redonda para jamba de 20 a 30mm.

• Rounded side hinge for door-jambs of 20 to 30mm.

• Rundes seitliches Scharnier für Türpfosten von 20 bis 30mm.

• Charnière latérale ronde pour chambranles de 20 à 30 mm.

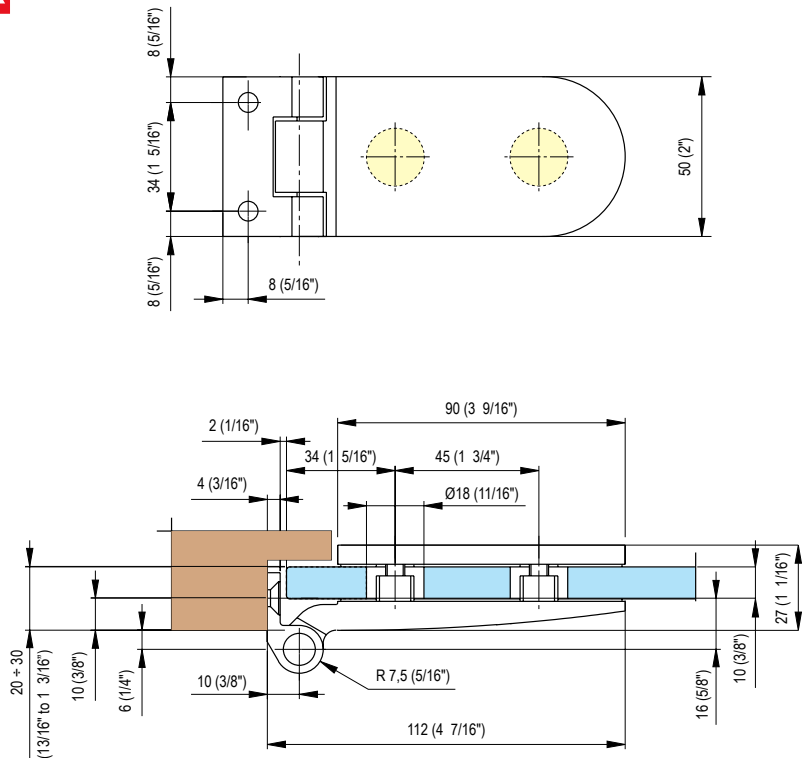
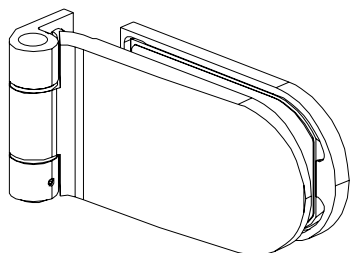

8662

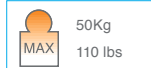
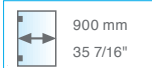
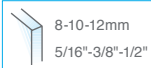

- Cerniera tonda doppia vetro-vetro. 180°.
- Bisagra redonda doble vidrio-vidrio. 180°.
- Rounded double side hinge glass to glass. 180°.
- Rundes Doppelscharnier Glas-Glas. 180°.
- Double charnière ronde verre-verre. 180°.

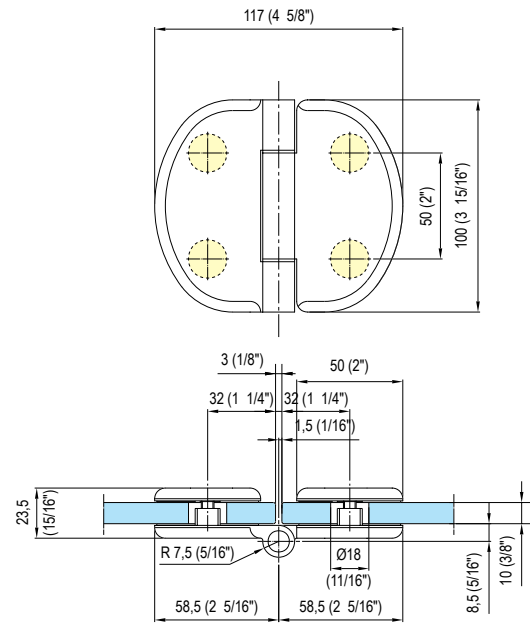
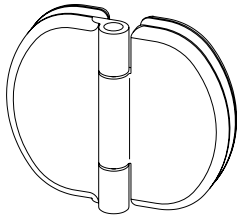

8663

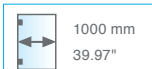
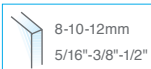

- Cerniera laterale tonda per stipite stretto.
- Bisagra redonda lateral.
- Rounded side hinge for narrow door jambs.
- Rundes, seitliches Scharnier für schmale Türpfosten.
- Charnière latérale ronde pour chambranle étroit.

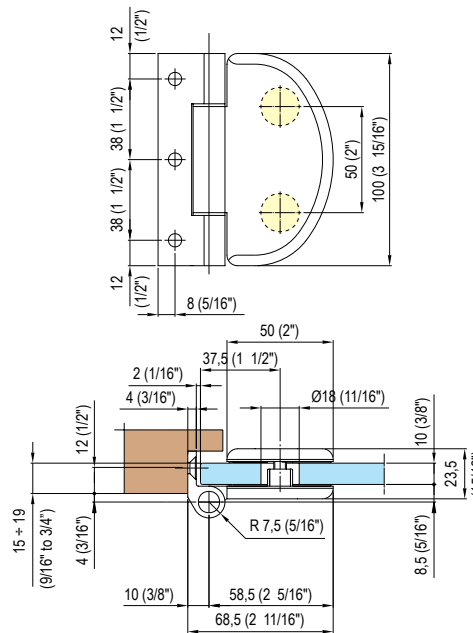
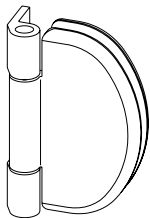

8664

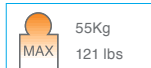
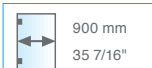
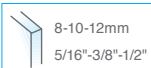

- Cerniera laterale tonda per stipiti da 30 a 42mm.
- Bisagra redonda lateral para jamba de 30 a 42mm.
- Rounded side hinge for door-jambs of 30 to 42mm.
- Rundes, seitliches Scharnier für Türpfosten von 30 bis 42mm.
- Charnière latérale ronde pour chambranle de 30 à 42mm.

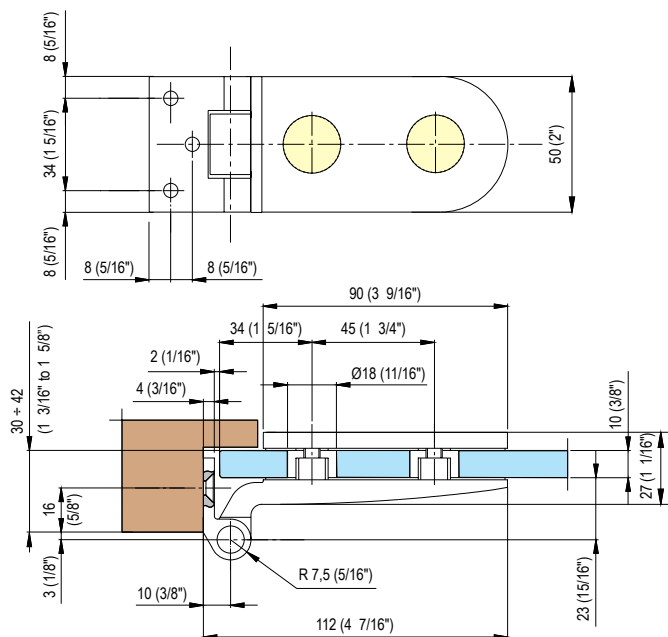
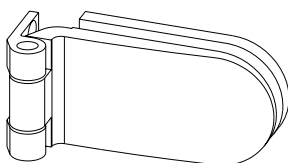

8665

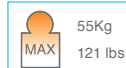
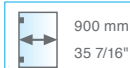
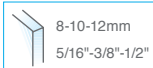

- Cerniera laterale per stipiti da 30 a 42mm.
- Bisagra lateral para jamba de 30 a 42 mm.
- Side hinge for door-jambes of 30 to 42mm.
- Seitliches Scharnier für Türpfosten von 30 bis 42mm.
- Charnière latérale pour chambranle de 30 à 42mm.

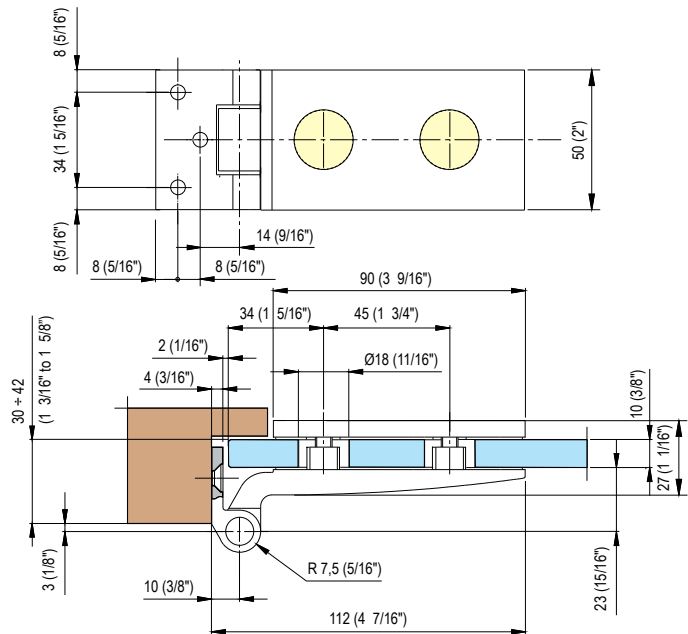
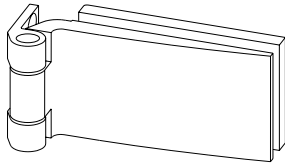

8810

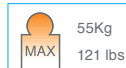
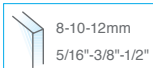

- Cerniera laterale FLEXA.
- Bisagra lateral FLEXA.
- Side hinge FLEXA.
- Seitliches Scharnier FLEXA.
- Charnière latérale FLEXA.

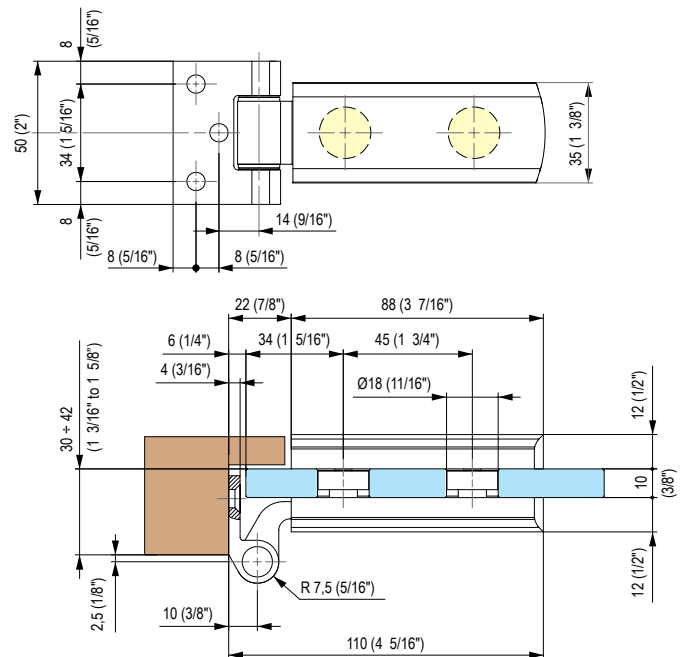
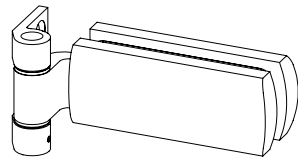

8666

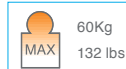
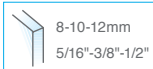

- Cerniera laterale tonda per stipiti da 40 a 50mm.
- Bisagra redonda lateral para jamba de 40 a 50mm.
- Rounded side hinge for door-jambes of 40 to 50mm.
- Abgerundetes seitliches Scharnier für Türpfosten von 40 bis 50mm.
- Charnière latérale ronde pour chambranle de 40 à 50mm.

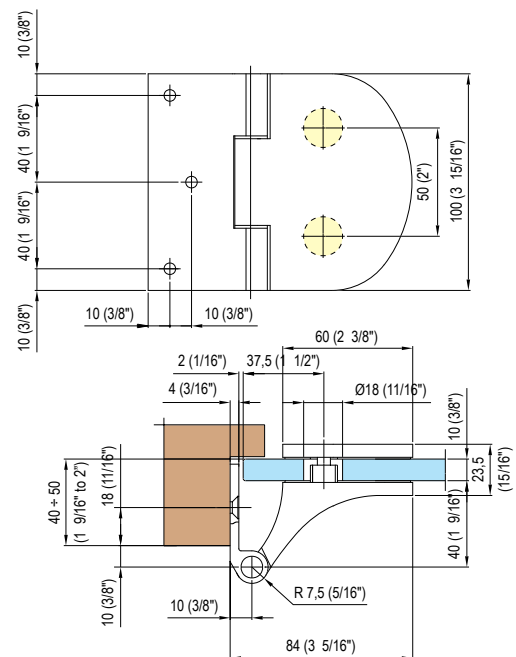
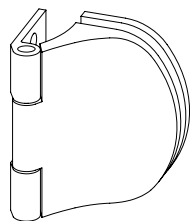

8667



8-10-12mm
5/16"-3/8"-1/2"

1000 mm
39.37"

60Kg
132 lbs
MAX

- Cerniera laterale per stipiti da 40 a 50mm.
- Bisagra lateral para jamba de 40 a 50 mm.
- Side hinge for door-jambs of 40 to 50mm.
- Seitliches Scharnier für Türpfosten von 40 bis 50mm.
- Charnière latérale ronde pour jambage de 40 à 50mm.

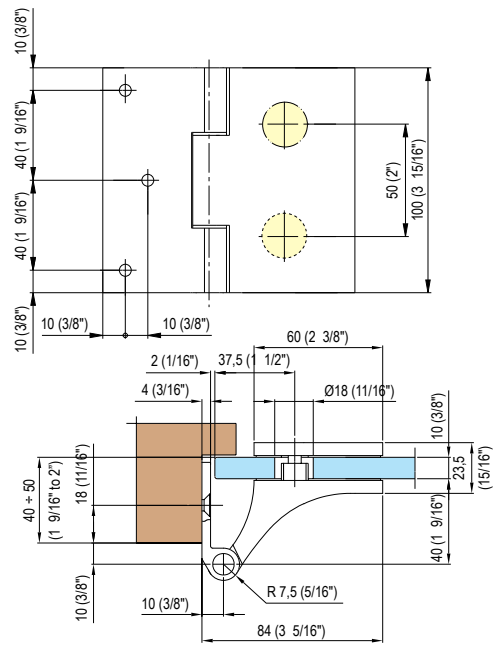
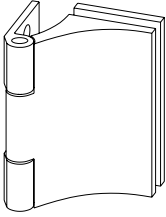

8674

8-10-12mm
5/16"-3/8"-1/2"

1000 mm
39.37"

60Kg
132 lbs
MAX

- Cerniera laterale per stipiti da 30 a 42mm.
- Bisagra lateral para jamba de 30 a 42mm.
- Side hinge for door-jambs of 30 to 42mm.
- Anschlagtürband für Falztiefen von 30 bis 42mm.
- Charnière latérale pour chambranle de 30 à 42mm.

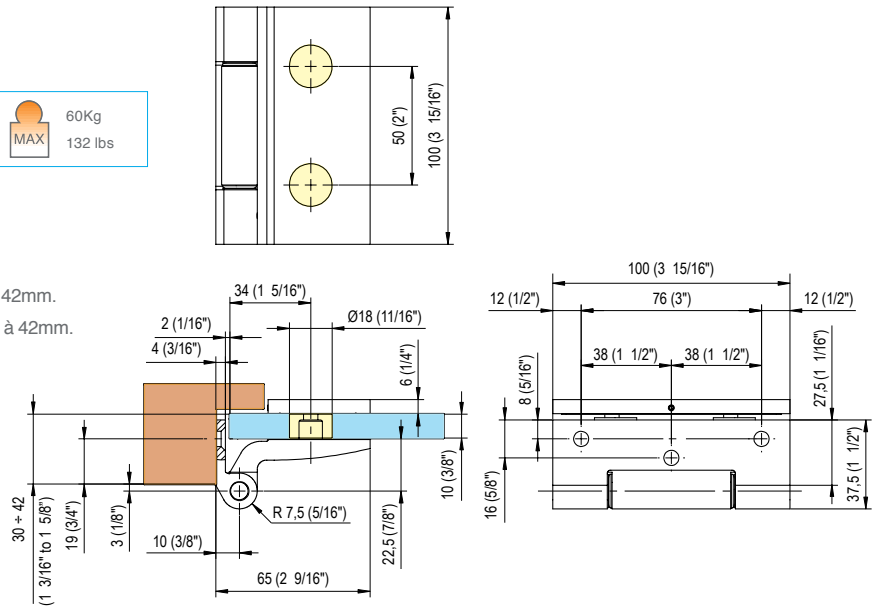
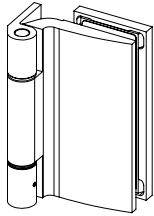

8SI0

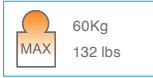
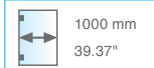
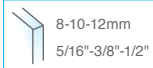

- Cerniera laterale stipite da 45mm con piastrina di fissaggio.
- Bisagra lateral con placa de fijación: plancha de 45mm.
- Side hinge for door-jamb of 45mm with fixing plate.
- Seitliches Scharnier für Türpfosten von 45mm mit Befestigungsplatte.
- Charnière latérale avec jambage de 45mm et plaque de fixation.

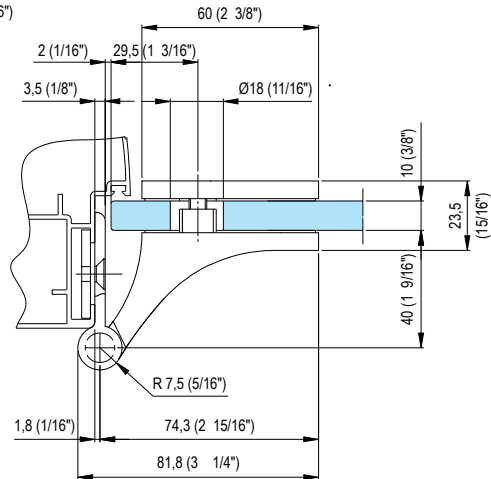
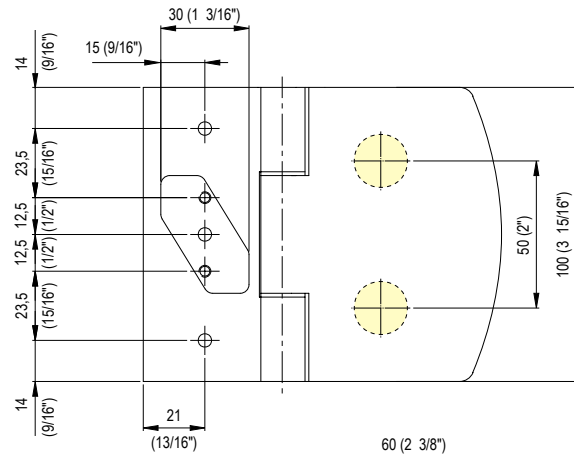
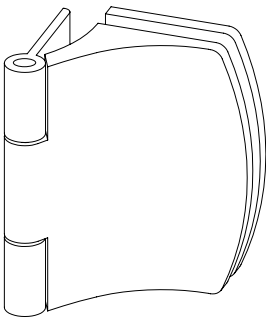

8SI1



- Cerniera per porte in legno.
- Bisagra para puertas de madera.
- Hinge for wooden doors.
- Scharnier für Holztüren.
- Charnière pour portes en bois.

