

# FLUIDO+

TAPPI / CAPS B070 B110 B150

B110EK66

B110EK66

B110EK66

B110EK67

B150EK66

B150EK66

B150EK66

B150EK67



## OPERAZIONE PRELIMINARE PER VERSIONE ATTACCO A MURO

PRELIMINARY OPERATION FOR WALL MOUNTING VERSION

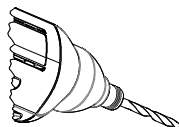

FORO VITE Ø5mm  
SCREW HOLE Ø5mm

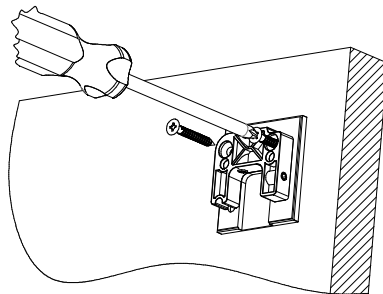
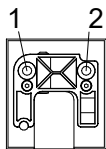
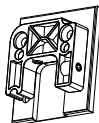

FORARE LA PARTE METALLICA NELLE 2 POSIZIONI INDICATE  
DRILL THE METAL PART IN THE 2 INDICATED POSITIONS

FISSARE AL MURO CON TASSELLI - VITE Ø 5mm  
FIX TO THE WALL WITH PLUG - 5mm SCREW Ø

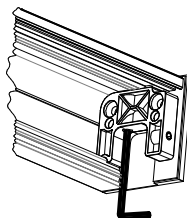
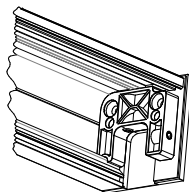
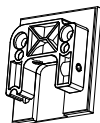
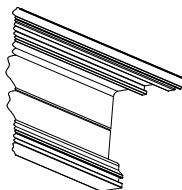

POSIZIONARE IL TAPPO  
PLACE THE CAP

BLOCCARE CON BRUGOLA  
LOCK WITH ALLEN

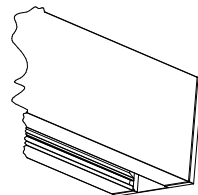
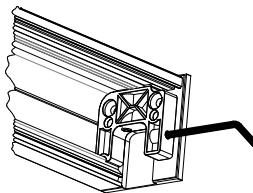
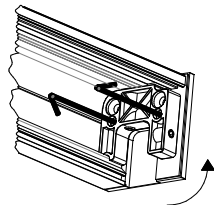

AGGIUSTARE LA POSIZIONE DEL  
TAPPO AGENDO SULLE VITI  
ADJUST THE CAP POSITION BY ACTING  
ON THE SCREWS

AGGIUSTARE LA POSIZIONE DELLA  
VELINA AGENDO SULLA VITE  
ADJUST THE COVER POSITION BY ACTING  
ON THE SCREW

POSIZIONARE LA VELINA  
PUT THE COVER